



Installation Guide & User's Manual Garmin Force Kraken

Contact Us

Please feel free to contact us with any questions, comments or concerns.

Phone: (321) 208-4590
Email: info@pwrpux.com
Web: pwrpux.com



PRODUCT PATENTED. ALL RIGHTS RESERVED



Product Patented. All Rights Reserved

Power Pux



LIMITED THREE YEAR WARRANTY

The World's First Power Supplied Trolling Motor Quick Release Bracket

Please log into www.pwrpux.com to activate your Warranty

Product not compatible with Trolling Motors with shafts of 96" inches or longer.

What you may need

1. 8 Gauge insulated Wire. (Enough to reach from the batteries or battery terminal Busbar to the bow Puck)
2. Your own stainless hardware for mounting the Puck to the deck. Use four ¼"-20 Flat Head Screws, Nyloc Nuts and Large Fender Washers or Backing Plate.
3. BoatLife LifeSeal Caulking
4. Acetone
5. Clean Rags
6. Lead Pencil
7. Wire cutters
8. Wire Crimping Tool
9. Heat gun or small Butane Torch
10. 13/64" Drill Bit
11. ¾" inch Hole Saw or Spade Bit
12. 60 AMP surge protection breaker with trip switch
13. #2 & #3 Phillips Screwdrivers
14. 7/16" Socket & Wrench

NOTE: Some boat designs may require a Fish Tape or similar device to pull wires through inaccessible compartments.

POWER PUX LIMITED THREE-YEAR WARRANTY ON THE ENTIRE PRODUCT

Power Pux, Inc. extends the following limited warranty to the original retail purchaser only. Warranty coverage is not transferable.

Power Pux Limited Three-Year Warranty on the Entire Product warrants to the original retail purchaser only that the purchaser's new Power Pux accessory will be materially free from defects in materials and workmanship appearing within one (3) years after the date of purchase. Power Pux will (at its option) either repair or replace, free of charge, any parts found by Power Pux to be defective during the term of this warranty. Such repair, or replacement shall be the sole and exclusive liability of Power Pux and the sole and exclusive remedy of the purchaser for breach of this warranty.

EXCLUSIONS AND LIMITATIONS

This limited warranty does not apply to products that have been used commercially or for rental purposes. This limited warranty does not cover normal wear and tear, blemishes that do not affect the operation of the product, or damage caused by accidents, abuse, alteration, modification, shipping damages, acts of God, negligence of the user or misuse, improper or insufficient care or maintenance. **DAMAGE CAUSED BY THE USE OF OTHER REPLACEMENT PARTS NOT MEETING THE DESIGN SPECIFICATIONS OF THE ORIGINAL PARTS WILL NOT BE COVERED BY THIS LIMITED WARRANTY.** The cost of normal maintenance or replacement parts which are not in breach of the limited warranty are the responsibility of the purchaser. Prior to using products, the purchaser shall determine the suitability of the products for the intended use and assumes all related risk and liability. Any assistance Power Pux provides to or procures for the purchaser outside the terms, limitations or exclusions of this limited warranty will not constitute a waiver of the terms, limitations or exclusions, nor will such assistance extend or revive the warranty. Power Pux will not reimburse the purchaser for any expenses incurred by the purchaser in repairing, correcting or replacing any defective products or parts, except those incurred with Power Pux prior written permission. **Power Pux AGGREGATE LIABILITY WITH RESPECT TO COVERED PRODUCTS IS LIMITED TO AN AMOUNT EQUAL TO THE PURCHASER'S ORIGINAL PURCHASE PRICE PAID FOR SUCH PRODUCT.**

HOW TO OBTAIN WARRANTY SERVICE To obtain warranty service in the U.S., the product believed to be defective, and proof of original purchase (including the date of purchase), must be presented to a Power Pux Authorized Service Center or to Power Pux factory service center in Cocoa FL. Any charges incurred for service calls, transportation or shipping/freight to/from the Authorized Service Center or factory, labor to haul out, remove, re-install or re-rig products removed for warranty service, or any other similar items are the sole and exclusive responsibility of the purchaser. Products purchased outside of the U.S. must be returned prepaid with proof of purchase (including the date of purchase and serial number) to any Authorized Power Pux Service Center in the country of purchase. Warranty service can be arranged by contacting a Power Pux Authorized Service Center or by contacting the factory by email infp@pwrpux.com. Products repaired or replaced will be warranted for the remainder of the original warranty period [or for 90 days from the date of repair or replacement, whichever is longer]. For any product that is returned for warranty service that Power Pux finds to be not covered by or not in breach of this limited warranty, there will be a billing for services rendered at the prevailing posted labor rate and for a minimum of at least one hour.

NOTE: Do not return your Power Pux product to your retailer. Your retailer is not authorized to repair or replace products.

THERE ARE NO EXPRESS WARRANTIES OTHER THAN THESE LIMITED WARRANTIES. IN NO EVENT SHALL ANY IMPLIED WARRANTIES INCLUDING ANY IMPLIED WARRANTIES OF MERCHANTABILITY OR FITNESS FOR PARTICULAR PURPOSE, EXTEND BEYOND THE DURATION OF THE RELEVANT EXPRESS LIMITED WARRANTY. IN NO EVENT SHALL POWER PUX BE LIABLE FOR PUNITIVE, INDIRECT, INCIDENTAL, CONSEQUENTIAL OR SPECIAL DAMAGES. Without limiting the foregoing, Power Pux assumes no responsibility for loss of use of product, loss of time, inconvenience or other damage. **HOW DOES STATE LAW APPLY?** Some states do not allow limitations on how long an implied warranty lasts or the exclusion or limitation of incidental or consequential damages, so the above limitations and/or exclusions may not apply to you. This warranty gives you specific legal rights and you may also have other legal rights which vary from state to state.

Power Pux

The World's First Power Supplied Trolling Motor
Quick Release Bracket



Use and Maintenance:

The electrical plug connectors come pretreated with Marine Grade Corrosion X HD Corrosion Inhibitor for corrosion resistance.

Use the included Gray Rubber Plug Cap to protect the Deck Puck Plug when the trolling motor is removed from the boat.

Please check these connections often and reapply Corrosion X HD Corrosion Inhibitor as needed for ultimate extended performance.

NOTE: Use of a 60 AMP in-line breaker is required to protect the trolling motor motherboard and to avoid electrolysis. Please turn off the inline trolling system breaker at the end of each trip.

Installation Instructions

Thank you for your recent purchase of Power Pux, the World's first Power Supplied Trolling Motor Quick Release Bracket.

Now let's get started in assembling this to your trolling motor and get it mounted on your boat.

In the box, you will find the full kit including the hardware needed to secure the bracket to your trolling motor, (2) red and (2) black heat shrink tubing, and a gray rubber end cap to cover and protect the plug on your deck puck when not in use.

You will need to supply your own hardware to mount the Puck to your deck. The length and style of that hardware will depend on the thickness and material type of your deck and/or whether you will be using backing plates, washers or simply tapping into a solid material. **Do not use tapping Screws. The Puck must be thru-bolted using at least four ¼-20 Flat Head Machined Screws.**

Oval-Head screws will rub and damage the Receiver bracket, thus making it hard to remove the trolling motor from the Deck Puck.

Please note: The puck may not be removable until the bracket is firmly attached to your trolling motor base. Please perform these following steps in the order that they are written.

1. First, locate the hardware package and identify the (6) ¼ -20 x 2" Flat Head machine threaded screws and Nylock Jam nuts. **Do not use fender washers or damage can occur to the Powder Coat on the trolling motor steering housing.**
2. Next, remove the side panels of your trolling motor base and set them to the side.
3. Deploy the trolling motor to access the Control Module.
4. Unplug and remove the Control Module. **See Fig 1 page 7.**

Illustrations

5. Now, align the Power Pux bracket with the pre-drilled holes in the trolling motor base. Be sure the puck wires are exiting down and the wire exit hole in the Power Pux bracket is facing towards the rear of the trolling motor base. This is where you will connect the wires from the trolling motor to the Power Pux Bracket. **See Fig 2 page 7.**
6. Insert the six Flat Head screws into the countersunk holes in the bottom of the bracket and secure them firmly to the trolling motor base using the six Nylock Jam nuts. Index (turn) the nuts to ensure they fit into the hex shaped notches under the Garmin Steering Motor housing.
7. Using firm pressure, remove the Stainless Power Pux locking pin.
8. You can now remove the puck from the bracket. **Do not pull the wires. Use the Locking Pin to pull the Puck by inserting it into one of the two aft puck mounting holes. Lift pin slightly to avoid scratching the bracket.**

Now it's Time to connect the trolling motor to the power plug.

9. Deploy the trolling motor to provide access to the trolling motor wire harness.
10. Cut the Trolling motor wire harness flush with the back-end of the Power Pux Bracket. **See Fig 3 page 8**
11. Cut and remove approximately 4 inches of the black exterior wire harness insulation cover to expose the 4 wires and remove all excess insulation and the small black wire separating cord found inside the harness.
12. Strip the black and red wire insulators on the ends of all 4 wires to expose 3/8" of an inch of bare wires.

Note: You can remove the Power Plug from the Power Pux Receiver Bracket to make the next step easier when crimping the wires together.

Figure 4

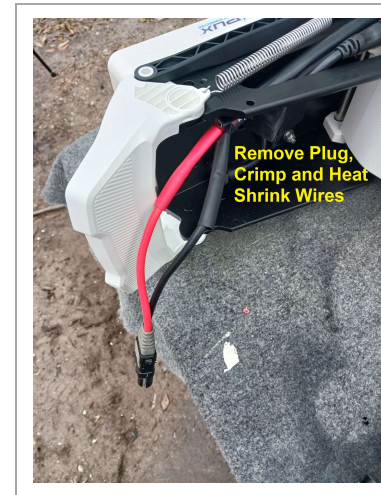

Crimp and Heat Shrink Wires

Figure 5



Install wire Loom and Reinstall Plug. See Caution in step 15.

Illustrations

Figure 1



Unplug and carefully remove Control Module. There is one screw securing the module, located below the plug. Then slide forward slightly to release the module. Take note of the plastic lip that secures the module on the aft side for reassembly purposes.

Figure 2



Correct Orientation. Install the 6 provided 1/4-20 x 2" inch Flathead Screws and Jam Nuts.

Figure 3



Cut the wire harness flush with the rear end of the Power Pux Bracket.

- Slide the provided red and black heat shrink tubing over the wires **first** and then insert and crimp all (4) 10 Gauge trolling motor wires (2 Reds to Red & 2 Blacks to Black) together inside the 6 gauge wire connectors already attached to the plug wires. Slide the heat shrink jackets over the butt connectors and center so that the heat shrink is covering equal lengths of the wire insulation on each end of the connectors. Using a heat gun or small butane torch, heat the heat shrink jackets until visibly waterproof around the wires and connectors. **See Fig 4 page 8**
- Use the included Black Wire Loom to cover the entire wire harness down to the base of the Power Plug and secure with the provided black wire ties. **See Fig 5 Page 8**
- Reinstall the Power Plug and cover plate. **Use caution to avoid damage to the stainless anchor pin on the plug while lining it up and inserting it into the small predrilled hole in the Power Pux Bracket. The pin must be inserted fully into the small hole in the bracket for proper alignment.**
- Reassemble the control module and side panels in the reverse order that they were removed. Remember to plug-in the module.

You are now ready to install the Deck Puck

If the Puck will be extending beyond the flat surface of the deck, you MUST use an aluminum mounting plate underneath the puck for support. See our Aluminum Pulpit Extension for reference.

**** PLEASE ENSURE THE BATTERY SWITCH IS TURNED OFF AND/OR DISCONNECT THE BATTERIES BEFORE FOLLOWING THE NEXT STEPS****

- Place the entire trolling motor assembly on the deck in your desired location. Deploy the trolling motor to ensure the shaft clears the rub rail according to the trolling motor manufacturer's specifications. Mark the location of the Power Pux Quick Release Bracket with a lead pencil on your deck once you are satisfied with the mounting location. **Note: Be sure to check for obstacles on the underside of the deck before drilling any holes.**

18. Place the provided template within the pencil lines on your deck and mark the (4) mounting holes and the 3/4" inch wire hole with a lead pencil.
19. Drill the (4) 1/4" inch mounting holes.
NOTE: If you have a hard solid material laminated into your deck, Use a 1/4"-20 Tap kit and use four 1/4x20 Flat Head Screws to secure the puck.
20. Drill the wire hole using a 3/4" inch hole saw or spade bit. The spade bit works best when drilling through hard Phenolic board materials.
21. Determine the best wire chase option from your batteries and run your 8 gauge wires thru the wire hole in your deck.
Note: A 60 amp surge protection breaker is required to be used in-line with the red power wire between the batteries and the trolling motor puck. You must trip/turn off the breaker at the end of each day before storing your boat and before charging your batteries to avoid prolonged electrolysis which can damage your power plugs and your trolling motor's internal motherboard.
22. Cut the exposed wires from the batteries to the desired length and strip the wire insulator on the ends to expose 3/8" of an inch of bare wire.
23. Slide one of the provided red and one of the black heat shrink tubes over the wires **before** inserting and crimping the wires (Red to Red & Black to Black) using the included wire butt splice connectors. Using a heat gun or small butane torch, center and heat the heat shrink tubing until visibly waterproof around the wires and connectors.
24. Apply an ample amount of BoatLife LifeSeal caulking around all (4) screw holes, the wire hole and inside the entire parameter of the Puck to eliminate water intrusion.
25. Thru-Bolt the Puck to the deck using at least four 1/4"-20 Flat Head Screws, Nyloc nuts and large backing washers or backing plate. **Be sure the power plug is facing aft.**

26. Clean all excess Sealant from around the parameter of the puck using Acetone or similar cleaning solvent.
27. Slide your trolling motor onto the puck in a forward motion, insert the locking pin. **Please see notes about padlock use below.**
28. Reconnect your batteries and Power Up your Trolling Motor.

****Notes about the use of a Padlock****

Use of a padlock is encouraged when your vessel is left unattended. Padlocks are not intended to hold up to excessive salt water exposure. Insure your Locking Pin is well secured when vessel is in use.

Use of a heavy duty plastic Cable Tie with a tensile strength of 75 Lbs. or higher can also be used to secure the locking pin.

You are ready to go fishing.

Turn your trolling motor on now and enjoy the benefits of a safe and cord free fishing deck.

Thank you again for choosing Power Pux

